

O2 Sensor Brochure

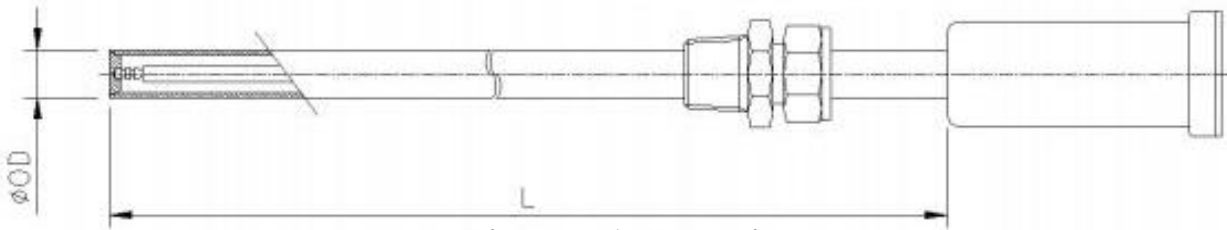

O2 Sensor



Picture 1. Drawing

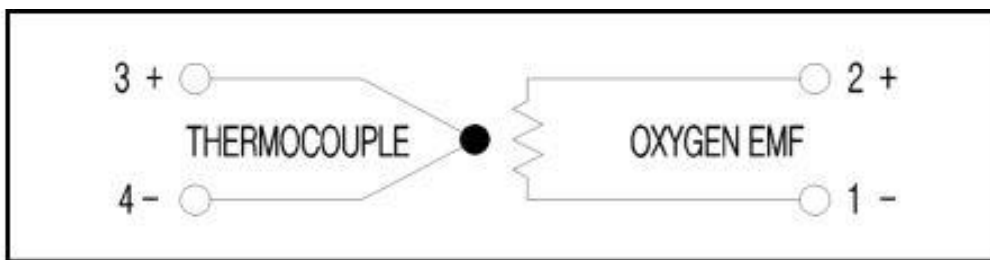

Picture 2. Carbon Probe Electrical Connection

Order Code

Model	T/C	Insertion Depth(L)	
CP-750-K1	K TYPE	750mm	27.5"

옵션 : 길이 변경가능, T/C TYPE 변경가능

Specification

● OUTPUT / THERMOCOUPLE

- 1.00 to 1.20 Vdc (1,000~1200mV) over carburizing range.
- K TYPE / R TYPE (OPTION)

● READOUT

- % carbon probe should be used with controlling, recording, and indicating instruments that have input impedance of 8 MegaOhms or higher.

● IMMERSION DEPTH

- 2 to 4 inches (50 ~ 100mm) (recommended).

● THERMAL SHOCK

- The special alloy protection tube acts as a heat sink that allows the alumina tube inside to change temperature at a slow rate.

● MECHANICAL SHOCK

- The protection tube is not subject to mechanical shock.
- The alumina tube inside has fair resistance to mechanical shock.

● WEIGHT / LENGTH

- Weight : 1.8kg / Length : 700mm / Shipping Weight : 2.5kg

● ACCURACY / RESPONSE TIME

- ± 0.05 weight % carbon in normal operating range / Less than 1.0 second.

● REFERENCE AIR

Uncontaminated air at recommended rate of 236cc/minute

● PROTECTION TUBE

- Special alloy is resistant to corrosion and oxidation up to 2012°F (1100°C).
- Very good mechanical strength.

● OPERATION TEMPERATURE

- Approx. 1400°F (760°C) to 2012°F (1100°C) - vertical mount
- Approx. 1400°F (760°C) to 1760°F (960°C) - horizontal mount

● AIR PURGE FITTING

- Allows connection of low flow (approximately 2 CFH / 566 LPM)
- Air supply to burn off accumulated carbon in probe

● ENDOTHERMIC ATMOSPHERES

- Millivolt readings for endothermic atmospheres generated from
- ATMOSPHERES methane (natural gas) and containing approximately 20% CO + CO₂

Intelligent Sensor Line Co.,Ltd



01 Thermocouple

다양한 종류의 열전대, RTD,
높은 정밀도 제작



02 O₂ Sensor

높은 온도에서도 높은 효율,
정확성, 내구성 고객맞춤형 제작



03 Recorder

사용이 쉽고 데이터 수집이
효과적인 다양한 종류의 레코더



04 PLC

PLC와 HMI를 하나로 통합
한 All-in-One 구성



05 Monitoring System

강력한 소프트웨어, 한번에
통합형 시스템을 구축



06 Wireless System

실시간으로 빠르고 정확한
데이터 수집, 스마트 무선시스템



Intelligent Sensor Line Co.,Ltd

THERMOCOUPLE&R.T.D.CONTROL.RECORDER.INFRARED.HEATER.PRESSURE.
FLOW.LEVEL.WIRELESS.SYSTEM.MEASURING METER.PLC+HMI

ISL계기(유)

TEL : (+8255) 238-1071~2